

Floor Box and Cover - Installation Instructions -

Instructions applicable to:

FBSR2X	Floor Box
BC2BRB	Cover
BC2BRN	Cover
BC2SRB	Cover
BC2SRN	Cover
BC2SFB	Cover
BC2SFN	Cover
BC2PRB	Cover
BC2PFB	Cover

FBS R2X Floor box is intended for installation in raised floors.

NOTE:

Minimum Floor Thickness: 5/8" (16 mm)
 Maximum Floor Thickness 1 1/4" (31 mm)

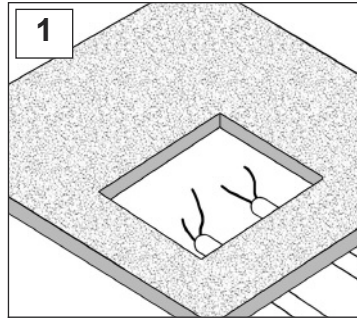

Determine box location and position in accordance to floor plan. Make a 9 3/16" (235 mm) by 8 1/16" (205 mm) cutout on the floor.

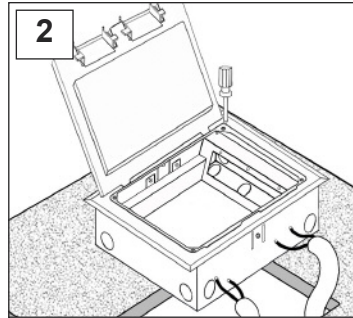

Pull 3/4" or 1" trade size flexible conduits through the floor cutout and attach them to the selected knockouts using conduit fittings. Attach the cover to the box using the four supplied screws.

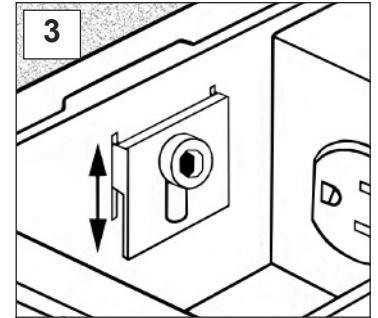

Drop the box on the floor cut out and adjust the position of the toggle until the box is secured to the floor

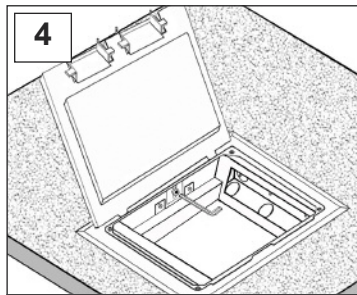

Fasten the Allen screws using a 5/32 allen wrench until the box is securely anchored to the floor. NOTE: For floor thicknesses from 1 - 1 1/4" remove the allen screw, rotate toggle 180° and install the toggle back in place.

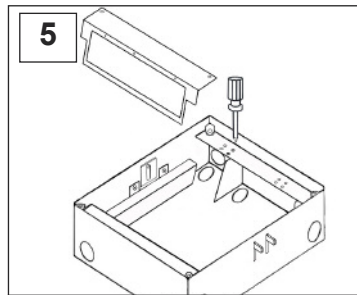

Barriers (sold separate) must be installed when placing line and low voltage devices on the same side of the box. To install barriers, remove the mounting panel. Install barriers accordingly (See Fig 1)

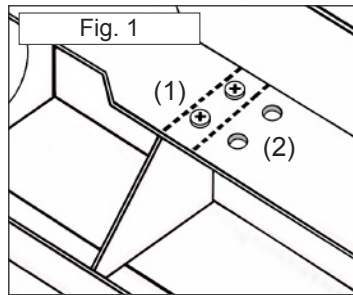

Position and install the barrier based on the selected faceplates:
 (1) Applies to faceplates 23601 and 23612
 (2) Applies to faceplate 24633



Warning:

To be installed and/or used in accordance with appropriate electrical codes and regulations.



Warning:

To avoid fire, electrical shock and/or electrocution turn power OFF at the circuit breaker before wiring.



Caution:

Wire devices in accordance with the NEC. If you are not sure about existing conductor wires, color coding, polarity and circuit feed contact a licensed electrician.

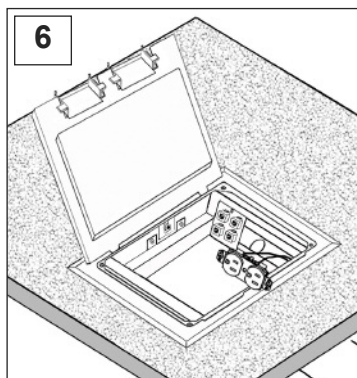

Locate and Pull wires. Wire the devices in accordance to the NEC.

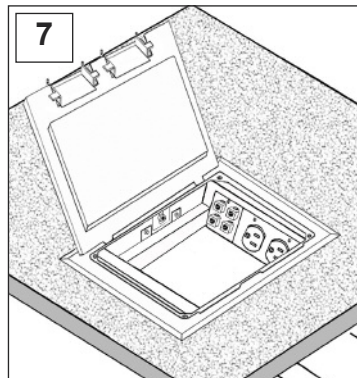

Attach devices to faceplates and secure them to the mounting panels. To install tunnels, remove the knockouts on the panels and screw the tunnels in position.

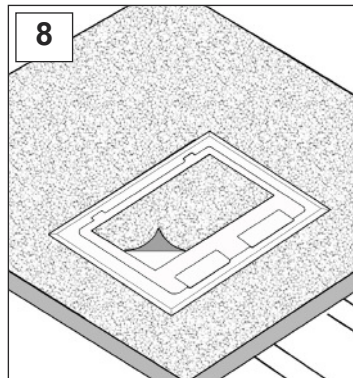

Install the desired floor covering material on top of the lid -if applicable- Recessed depth: 7/16" (12 mm)

Disclaimer - (Worldwide)
 FBS Floor Box Systems makes no warranties or representation, whatsoever, expressed or implied, as to the merchantability, fitness or suitability of this product.

Installer/Buyer of this product must verify the suitability or approval of this product for the specific use with the local codes and/or authorities having jurisdiction in the area where the product will be installed.